

A2 Compression Latch

Lever latch · Over-center action

Features

- Designed for heavy-duty applications
- Provides consistent gasket compression
- Built-in leverage helps open stuck doors
- Padlock option

Product Performance

- Maximum static load: 2,220 N
- Average ultimate load: 4,450 N

Material

- Base, lever, pawl and keeper: Malleable iron
- Links: 1065 steel
- Main crosspins: 10B21 steel
- Link pins: 1215 steel, zinc plated plus bright chromate dip
- Shim: 1010 steel, zinc immersion coating plus bright metallic organic coating
- Spring: 302 stainless steel, passivated
- Other pins: 302 stainless steel, passivated

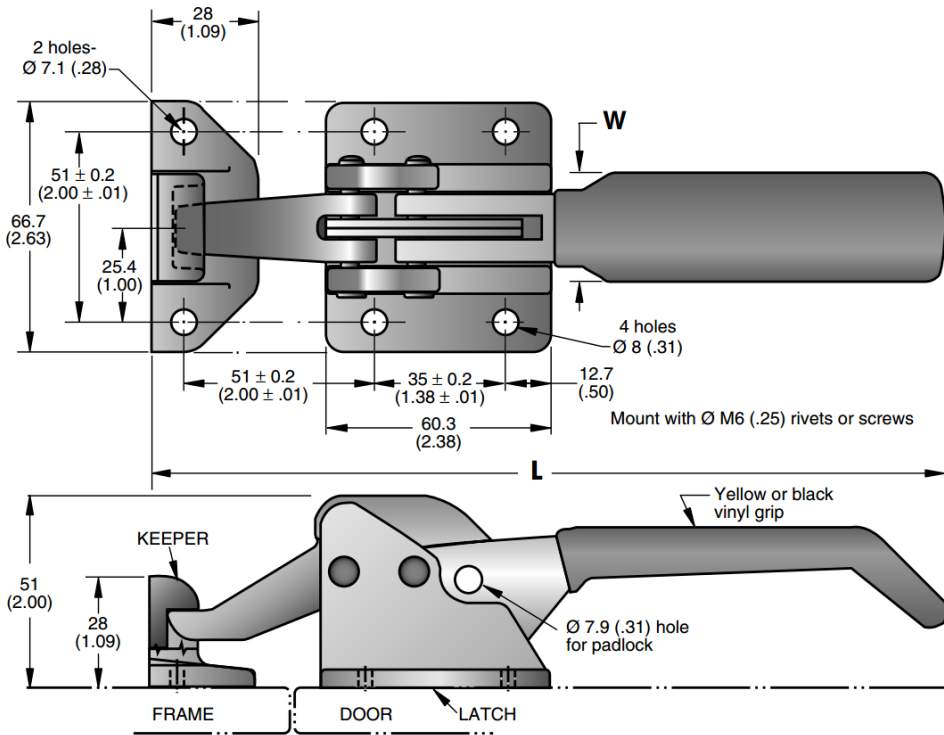

SHIM provided to make adjustments in latching plane of keeper when necessary.

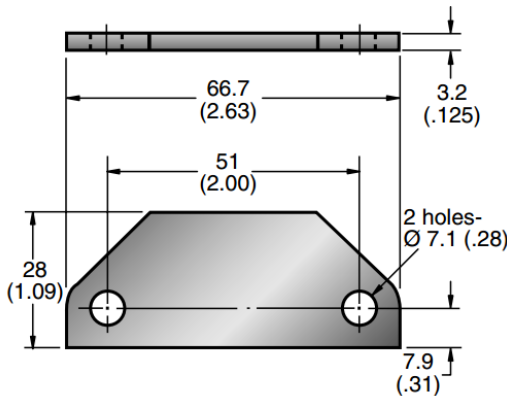

One supplied with each assembly.
For extra shims order part no.
A2-54-501-11.

STYLE	PART NUMBER	L	W
With plain handle	A2-10-501-10	211 (8.3)	25.4 (1.00)
With yellow vinyl handle grip	A2-10-501-22	214 (8.44)	30.2 (1.19)
With black vinyl handle grip	A2-10-501-21	214 (8.44)	30.2 (1.19)